

23 Garden Mews, Westcote Road, Reading, RG3C
2HD

£225,000 Leasehold



Walmsley Estate Agency are pleased to offer to the market this modern two bedroom first floor apartment, situated in a quiet residential setting, within close walking distance to Reading West train station as well as Reading Town Centre. The accommodation comprises of two double bedrooms, lounge/dining room, kitchen and bathroom with shower. Further benefits of this property include allocated parking space and communal gardens.

- * Length of original lease 125 years from 01 June 1999; approximately 100 years remaining.
- * Ground rent is currently £100. This does rise in November of this year to £200 and thereafter every 25 years it doubles to a maximum of £1600.
- * Service charge £2132.96 pa.
- * Council tax band C.
- * EPC - C.





Floor Plan

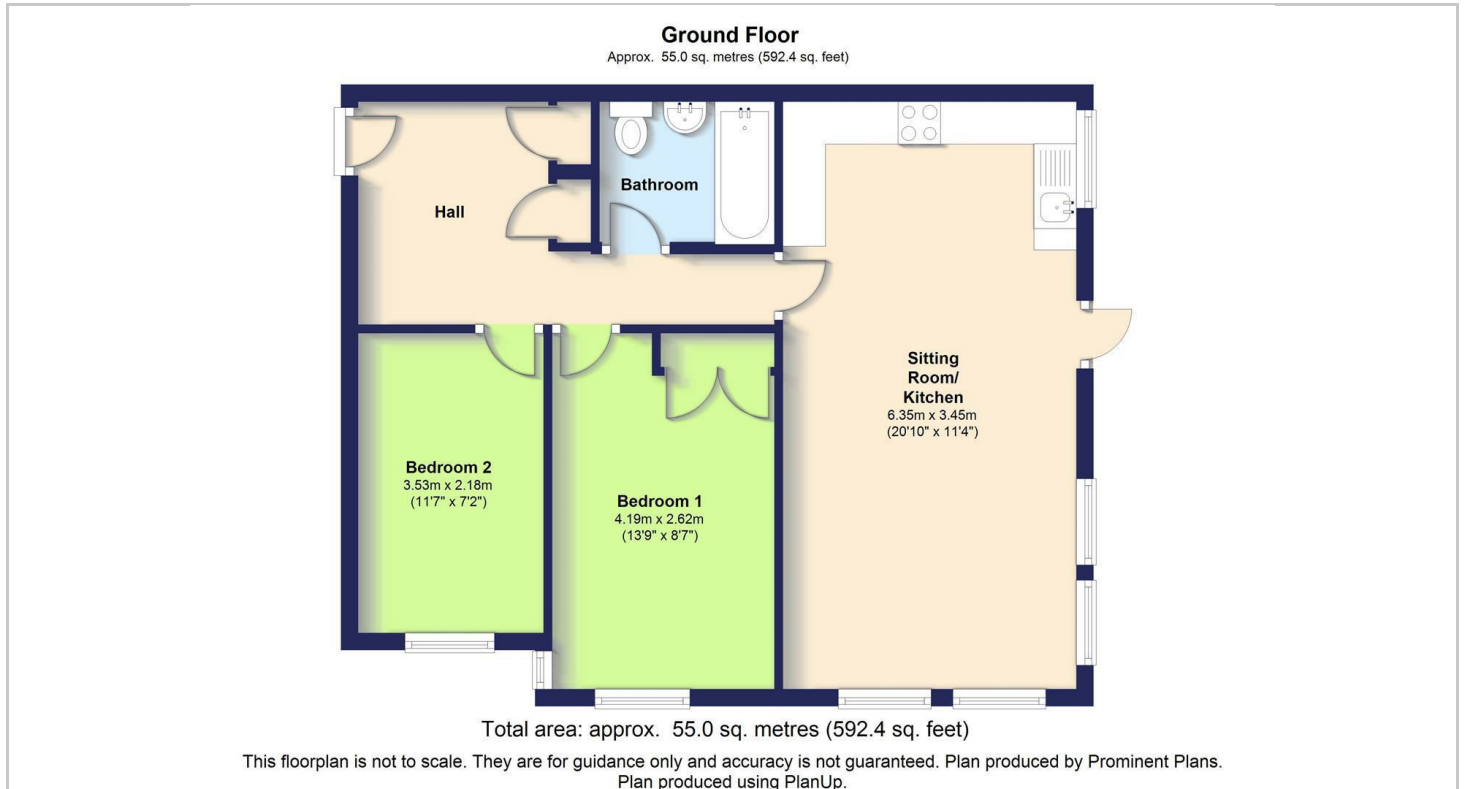

These particulars, whilst believed to be accurate are set out as a general outline only for guidance and do not constitute any part of an offer or contract. Intending purchasers should not rely on them as statements of representation of fact, but must satisfy themselves by inspection or otherwise as to their accuracy. No person in this firm's employment has the authority to make or give any representation or warranty in respect of the property.